



# Dolphin Yachts

INTERNATIONAL YACHT BROKERS

Dolphin Yachts S.L.

Club de Mar

07015 Palma de Mallorca

Spain

info@dolphin-yachts.com



## Cammenga 85

Fabricant:	Cammenga	Longueur hors tout:	26.00m (85'3")
Modèle:	85	Largeur:	6.10m (20'0")
Année:	1972	Tirant d'eau:	2.40m (7'9")
Matériau de la coque:	Acier	Carburant:	16.000 Litres
Aménagement:	8 berths in 4 cabins	Eau:	3.600 Litres
Architecte:	De Vries Lentsch	Moteurs:	2 x 172hp Gardner
Déplacement:	110 tons	Vitesse:	11 Knots

995.000 € TVA payée



**MOTEURS:**

2 x 172hp Gardner 6L3B

**VITESSE:**

Max: 11 knots aprox.

Croisière: 9,5 knots aprox.

**CAPACITÉ DES RESERVOIRS:**

Carburant: 16000 Litres

Eau: 3600 Litres

Eaux usées: 3200l

**ÉQUIPEMENTS MÉCANIQUES:**

CONTROL SYSTEM Cable Morse control system in wheelhouse.

PROP SHAFT Conventional type propeller shafts.

PROPELLERS 2 x 3 x blade bronze propellers

GENERATORS 2 x NORTHERN LIGHTS 30 Kw. Mod. M439 D30 □ L (11769hrs/11386 hrs. 17/07/2023)

AIR-CONDITIONING Several small older local units through the vessel.

Thermostat PPW 100.

WATERMAKER Idromar 100l/h

HYDRAULIC POWER PACK Installed in the engine room for Stabilisers

HYDRAULIC BOWTHRUSTER

STABILIZERS Vosper

STEERING GEAR hydraulic Tenfjord H 115 F.R.G.

CHARGERS: 1 Mastervolt 24 V / 75 A. 1 Mastervolt 24 V / 75 A newer model. 1 x 24v 25A Bridge. 1 x 24v 50A Engine Room

Shore power intake 380V in aft peak complete with cable.

Ship shore transformer in aft peak (original)

**AMÉNAGEMENT:**

Berths: 8

Cabins: 4

Head: 5

Crew Berths: 3

Crew Cabins: 1

The interior is built in the renown Dutch traditional style with the changed lay out incorporating the new cabin on the main deck and the relocation of the galley in the main saloon.

Master cabin on the main deck with headroom up to ± 187 cm - bed replaced 2017 with underbed storage. En-suite bathroom with shower.

VIP cabin with King-size bed of 195 x 150 cm, extra bunk berth and headroom up to ± 195 cm.

Spacious en-suite bathroom with toilet and walk in shower.

2 x spacious comfortable cabins twin cabins with headroom up to ± 192 cm and en-suite bathrooms with shower.

Day toilet on main deck

Wheelhouse located on the upper deck with desk and sofa. Access by stairs to saloon. Two observations seats with good visibility and direct access to main deck.

Crew cabin offering berths for a total of 3 crew headroom ca 205 cm and en-suite bathroom. (toilet replaced 2017)

Laundry on main deck with dryer and washing machine and storage space.

**EQUIPEMENTS D'AMÉNAGEMENT:**

Samsung TV in salon

**CARRÉ:**

Frontloading Liebherr fridge with freezer



4 ring Siemens ceramic hob  
Gaggenau Oven  
Gaggenau Microwave  
Extractor hood  
Miele Dishwasher  
Washing Machine AEG  
Dryer AEG

**NAVIGATION:**

Electric and Fluid Compass  
Log  
Depth sounder  
Navtex  
Chart plotter/Radar Simrad NX 45  
GPS  
Raymarine Autopilot (2013)  
VHF  
Satcom

**PONT:**

Large pilothouse on flybridge  
1 x Double original electric anchor winch  
2 x steel anchors, stowed on in stainless steel hull-shell pockets.  
2 x ± 100 m steel anchor chains 16mm stowed in chain lockers.  
Horizontal Capstan on anchor winch.  
2 Vertical Capstans on aft deck push-button controlled  
Tender Crane on fore deck, hydraulic. 1 x on Sundeck, electric  
Cushions for sun bed on upperdeck and for aftdeck seats and deck chairs  
Electric folding side-boarding ladder with small platform (2001)  
Hydraulic retractable passarelle (2000)  
Protector covers for exterior varnish(2020)  
Side covers on Flybridge(2021)  
Aft deck sun protection(2020)

**SÉCURITÉ:**

1 x firefighting system in engine room  
Several portable fire extinguishers.

**HISTOIRE SERVICE ET CONSTRUCTION:**

Hull repainted (2017)  
Superstructure repainted (2020)  
Build to Lloyds 100A1 Yacht LMC not under class anymore.  
Heavy displacement round bilged, canoe stern construction with flared bow.  
Built in approved SM grade 8 mm first sheet closest to keel and 6 mm hull. Steel bulwarks.  
5 watertight compartments by 4 bulkheads.  
One steel rudder fitted to skeg.  
Steel docking/bumper strips.  
Stainless steel bow protection plate, anchor hull-shell pocket.

**TANKS**

Fuel 1 x ± 1.820 litres steel fore tank with inspection manholes.  
1 x ± 2.437 litres steel fore tank with inspection manhole.  
1 x ± 3.343 litres steel fore tank with inspection manhole.  
1 x ± 1.500 litres steel centre tank engine room with inspection manhole.  
2 x ± 3.500 litres steel side tanks in engine room with inspection manholes



Total ± 16.000 litres.

4 x air pressure capacity meters.

2 x side tanks with glass capacity meters.

Fresh water 2 x ± 1.800 litres steel tanks with inspection manholes.

Glass capacity meters.

Grey/black water

1 x ± 1.800 litres steel bottom tank with inspection manhole in fore ship.

1 x ± 1.400 litres steel tank with inspection manhole in aft ship.

Electric Alarms

INSULATION

Thermal Hull over waterline and Superstructure insulated by glass wool, and sound damping foil.

Full out of the water service 9/2023

#### COMMENTAIRE DU COURTIER:

One of the famous Pacific Class 85 series that was built at Cammenga under Lloyds in 1972 by a design of W. de Vries Lentsch. Steel hull and superstructure with teak decks. Original layout has been changed with master cabin now on the main deck with ensuite bathroom. Below deck she offers 2 guest cabins all with bathrooms ensuite and one king VIP cabin. One crew cabin for 3 persons in the front. Powered by twin Gardners engines each 172 Hp. With the tender on the bow installed many square extra meters are available as deck area resulting in an amazing al Fresco area aft on the flybridge. She is a fine example of a proven timeless solid yacht build in the Netherlands. Her volume and practical layout makes her an ideal family yacht to cruise in style and elegance. Under 24m on paper.

#### EMPLACEMENT:

France





## Distribution

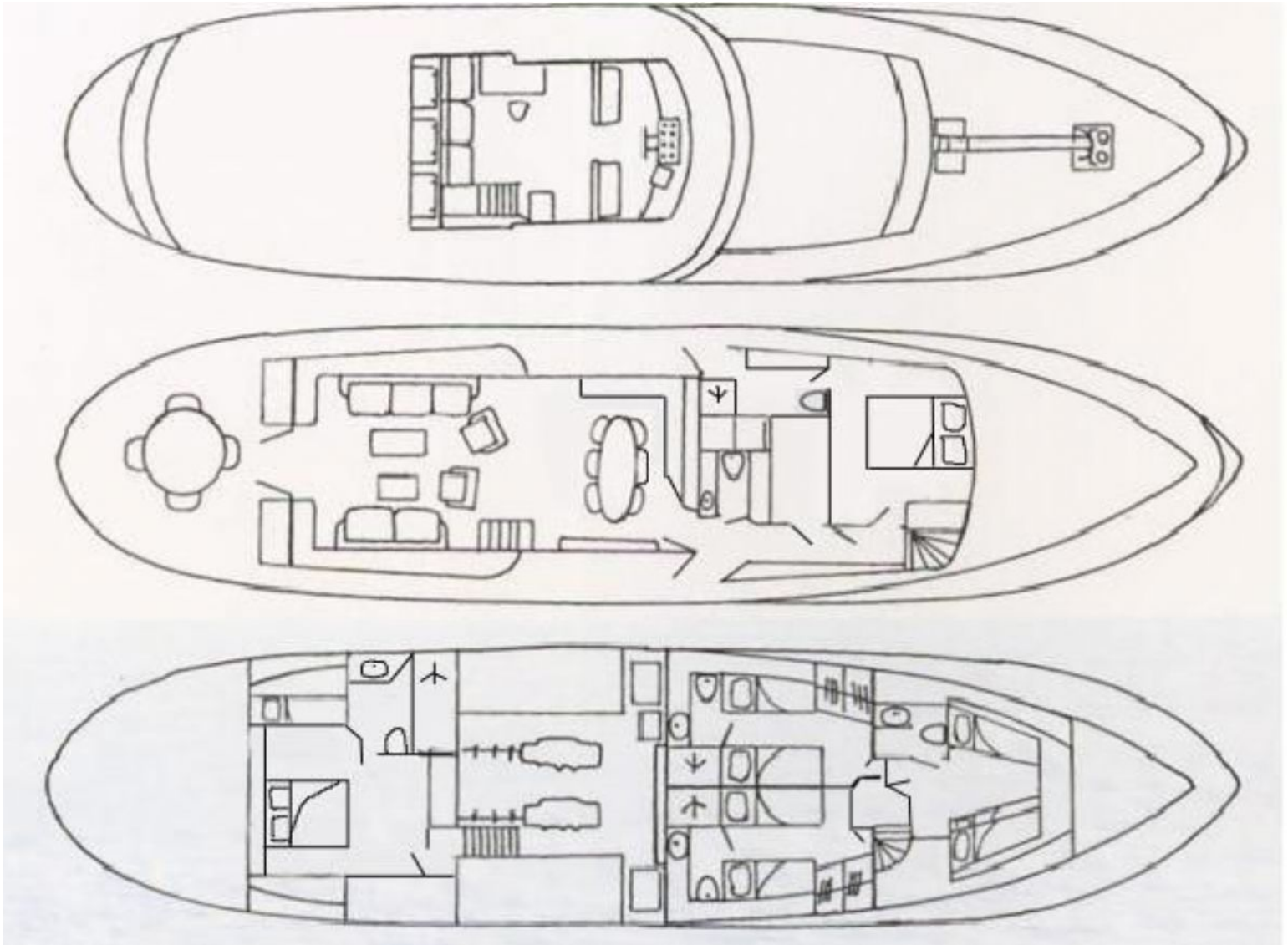

Les informations présentées dans cette brochure sont probablement correctes mais leur exactitude n'est pas garantie et ne pourra pas être utilisée pour un contrat. Une expertise Independent est toujours recommandée. Ce bateau peut être retiré de la vente sans préavis.