



Dolphin Yachts

INTERNATIONAL YACHT BROKERS

Dolphin Yachts S.L.

Club de Mar

07015 Palma de Mallorca

Spain

info@dolphin-yachts.com



Cammenga 85

Производитель:	Cammenga	Длина:	26.00m (85'3")
Модель:	85	Ширина:	6.10m (20'0")
Год выпуска:	1972	Осадка:	2.40m (7'9")
Материал:	Сталь	Топливо:	16.000 Litres
Размещение:	8 berths in 4 cabins	Вода:	3.600 Litres
Дизайнер:	De Vries Lentsch	Двигатели:	2 x 172hp Gardner
Водоизмещение:	110 tons	Скорость:	11 Knots

995.000 € НДС уплачен



Двигатели:

2 x 172hp Gardner 6L3B

Скорость:

Максимальная: 11 knots aprox.

Круизная: 9,5 knots aprox.

Вместимость:

Топливный бак: 16000 Litres

Бак пресной воды: 3600 Litres

Сточный бак: 3200l

Механическое оборудование:

CONTROL SYSTEM Cable Morse control system in wheelhouse.

PROP SHAFT Conventional type propeller shafts.

PROPELLERS 2 x 3 x blade bronze propellers

GENERATORS 2 x NORTHERN LIGHTS 30 Kw. Mod. M439 D30 □ L (11769hrs/11386 hrs. 17/07/2023)

AIR-CONDITIONING Several small older local units through the vessel.

Thermotank PPW 100.

WATERMAKER Idromar 100l/h

HYDRAULIC POWER PACK Installed in the engine room for Stabilisers

HYDRAULIC BOWTHRUSTER

STABILIZERS Vosper

STEERING GEAR hydraulic Tenfjord H 115 F.R.G.

CHARGERS: 1 Mastervolt 24 V / 75 A. 1 Mastervolt 24 V / 75 A newer model. 1 x 24v 25A Bridge. 1 x 24v 50A Engine Room

Shore power intake 380V in aft peak complete with cable.

Ship shore transformer in aft peak (original)

Размещение:

Berths: 8

Cabins: 4

Head: 5

Crew Berths: 3

Crew Cabins: 1

The interior is built in the renown Dutch traditional style with the changed lay out incorporating the new cabin on the main deck and the relocation of the galley in the main saloon.

Master cabin on the main deck with headroom up to ± 187 cm - bed replaced 2017 with underbed storage. En-suite bathroom with shower.

VIP cabin with King-size bed of 195 x 150 cm, extra bunk berth and headroom up to ± 195 cm.

Spacious en-suite bathroom with toilet and walk in shower.

2 x spacious comfortable cabins twin cabins with headroom up to ± 192 cm and en-suite bathrooms with shower.

Day toilet on main deck

Wheelhouse located on the upper deck with desk and sofa. Access by stairs to saloon. Two observations seats with good visibility and direct access to main deck.

Crew cabin offering berths for a total of 3 crew headroom ca 205 cm and en-suite bathroom. (toilet replaced 2017)

Laundry on main deck with dryer and washing machine and storage space.

Внутреннее оборудование:

Samsung TV in salon

Камбуз / Прачечное оборудование:

Frontloading Liebherr fridge with freezer



4 ring Siemens ceramic hob
Gaggenau Oven
Gaggenau Microwave
Extractor hood
Miele Dishwasher
Washing Machine AEG
Dryer AEG

Навигационное оборудование:

Electric and Fluid Compass
Log
Depth sounder
Navtex
Chart plotter/Radar Simrad NX 45
GPS
Raymarine Autopilot (2013)
VHF
Satcom

Оборудование палубы:

Large pilothouse on flybridge
1 x Double original electric anchor winch
2 x steel anchors, stowed on in stainless steel hull-shell pockets.
2 x \pm 100 m steel anchor chains 16mm stowed in chain lockers.
Horizontal Capstan on anchor winch.
2 Vertical Capstans on aft deck push-button controlled
Tender Crane on fore deck, hydraulic. 1 x on Sundeck, electric
Cushions for sun bed on upperdeck and for aftdeck seats and deck chairs
Electric folding side-boarding ladder with small platform (2001)
Hydraulic retractable passarelle (2000)
Protector covers for exterior varnish(2020)
Side covers on Flybridge(2021)
Aft deck sun protection(2020)

Аварийно-спасательное оборудование:

1 x firefighting system in engine room
Several portable fire extinguishers.

Ремонт и техобслуживание:

Hull repainted (2017)
Superstructure repainted (2020)
Build to Lloyds 100A1 Yacht LMC not under class anymore.
Heavy displacement round bilged, canoe stern construction with flared bow.
Built in approved SM grade 8 mm first sheet closest to keel and 6 mm hull. Steel bulwarks.
5 watertight compartments by 4 bulkheads.
One steel rudder fitted to skeg.
Steel docking/bumper strips.
Stainless steel bow protection plate, anchor hull-shell pocket.
TANKS
Fuel 1 x \pm 1.820 litres steel fore tank with inspection manholes.
1 x \pm 2.437 litres steel fore tank with inspection manhole.
1 x \pm 3.343 litres steel fore tank with inspection manhole.
1 x \pm 1.500 litres steel centre tank engine room with inspection manhole.
2 x \pm 3.500 litres steel side tanks in engine room with inspection manholes



Total ± 16.000 litres.

4 x air pressure capacity meters.

2 x side tanks with glass capacity meters.

Fresh water 2 x ± 1.800 litres steel tanks with inspection manholes.

Glass capacity meters.

Grey/black water

1 x ± 1.800 litres steel bottom tank with inspection manhole in fore ship.

1 x ± 1.400 litres steel tank with inspection manhole in aft ship.

Electric Alarms

INSULATION

Thermal Hull over waterline and Superstructure insulated by glass wool, and sound damping foil.

Full out of the water service 9/2023

Комментарии брокера:

One of the famous Pacific Class 85 series that was built at Cammenga under Lloyds in 1972 by a design of W. de Vries Lentsch. Steel hull and superstructure with teak decks. Original layout has been changed with master cabin now on the main deck with ensuite bathroom. Below deck she offers 2 guest cabins all with bathrooms ensuite and one king VIP cabin. One crew cabin for 3 persons in the front. Powered by twin Gardners engines each 172 Hp. With the tender on the bow installed many square extra meters are available as deck area resulting in an amazing al Fresco area aft on the flybridge. She is a fine example of a proven timeless solid yacht build in the Netherlands. Her volume and practical layout makes her an ideal family yacht to cruise in style and elegance. Under 24m on paper.

Местонахождение:

France





Схема яхты

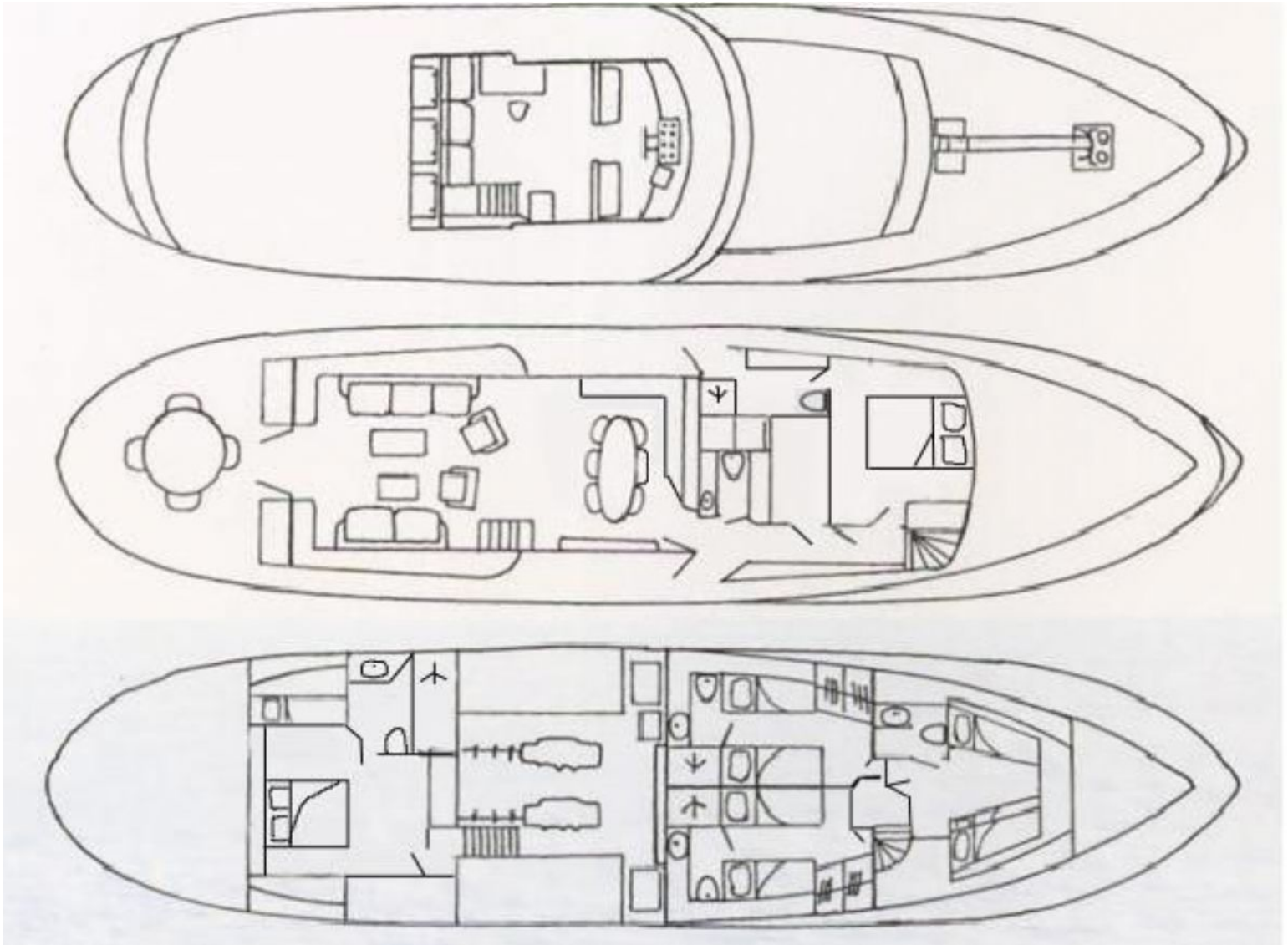

Все представленные выше данные основаны на информации, предоставленной продавцами. Данная информация считается достоверной, однако мы не несем ответственности за ее точность. Потенциальному покупателю настоятельно рекомендуется самостоятельно проверить предоставленную информацию и воспользоваться услугами квалифицированного морского эксперта и / или произвести проверку двигателей. В том случае, если проверка двигателей будет произведена нашей компанией, это не влечет никакой ответственности с нашей стороны.